

# Modern Detached House

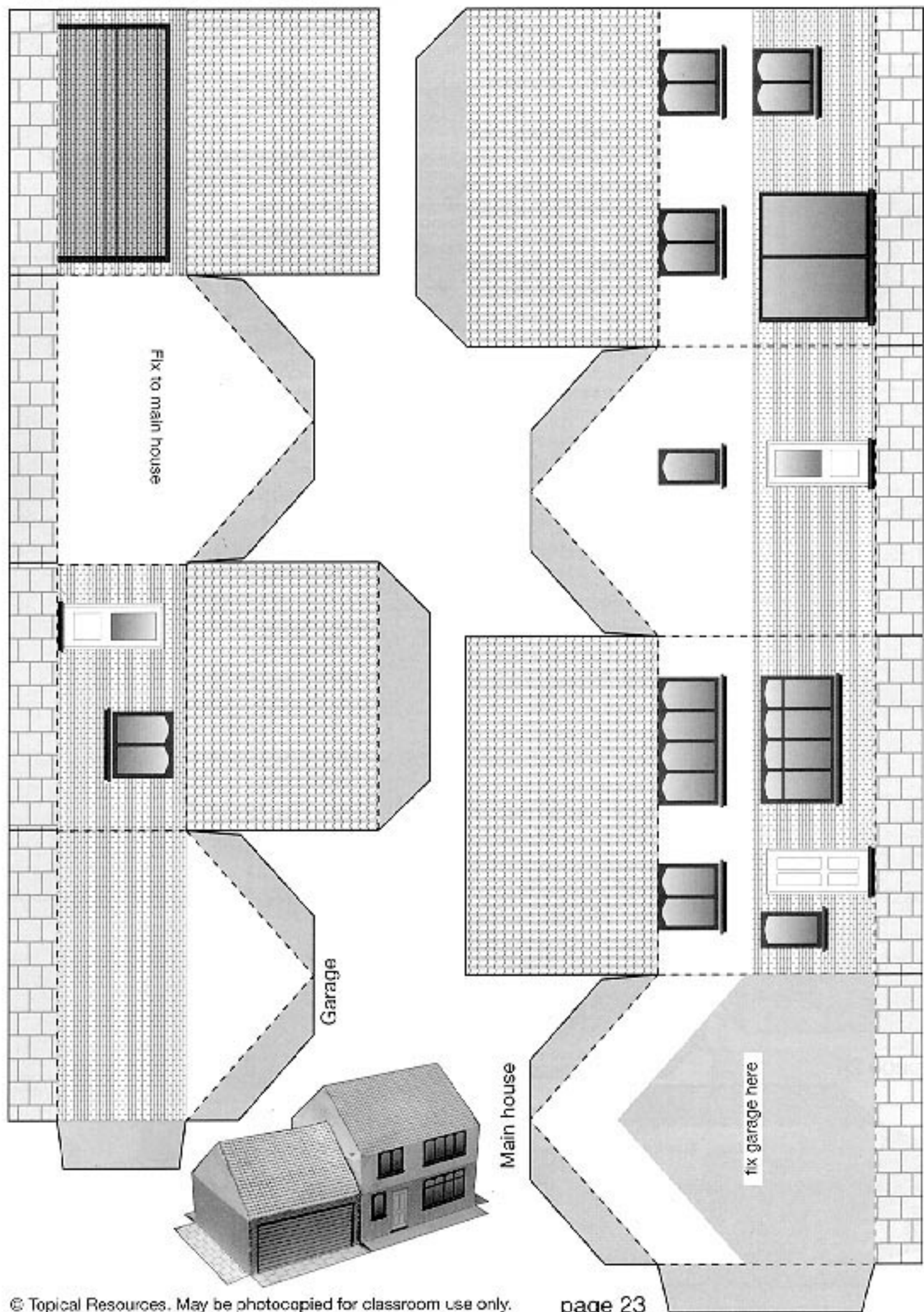

## The Life of a Lake District Farmer - (In a Country Settlement) - Level 2



My name is Richard. I look after sheep on a farm in the beautiful Lake District.



I live in a stone built farmhouse. It is nearly 300 years old.

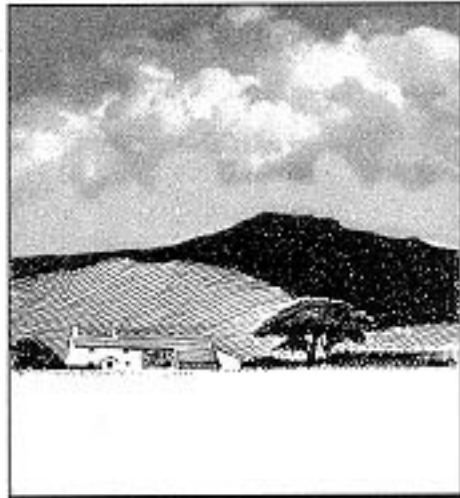

My house is in the middle of fields and close to mountains. It is often wet.



As well as keeping sheep, I mend cars and let people camp on our land, because farming does not pay as well as it used to.



Penrith is the nearest town. It is ten miles away.



My children go to a village school on a bus. It collects them from the farm gate every morning.

- 1 My name is \_\_\_\_\_. I look after sheep on a farm in the beautiful \_\_\_\_\_.
- 2 I live in a stone built \_\_\_\_\_. It is nearly \_\_\_\_ years old.
- 3 My house is in the middle of \_\_\_\_\_ and close to \_\_\_\_\_. It is often very \_\_\_\_\_.
- 4 As well as keeping \_\_\_\_\_, I mend \_\_\_\_\_ and let people \_\_\_\_\_ on our land, because farming does not pay as well as it used to.
- 5 \_\_\_\_\_ is the nearest town. It is about \_\_\_\_\_ miles away.
- 6 My children go to a \_\_\_\_\_ on a \_\_\_\_\_. It collects them from the farm gate every morning.

Carefully draw and colour your own picture of Richard at work.